

W. A. HESTER
SURVEYOR

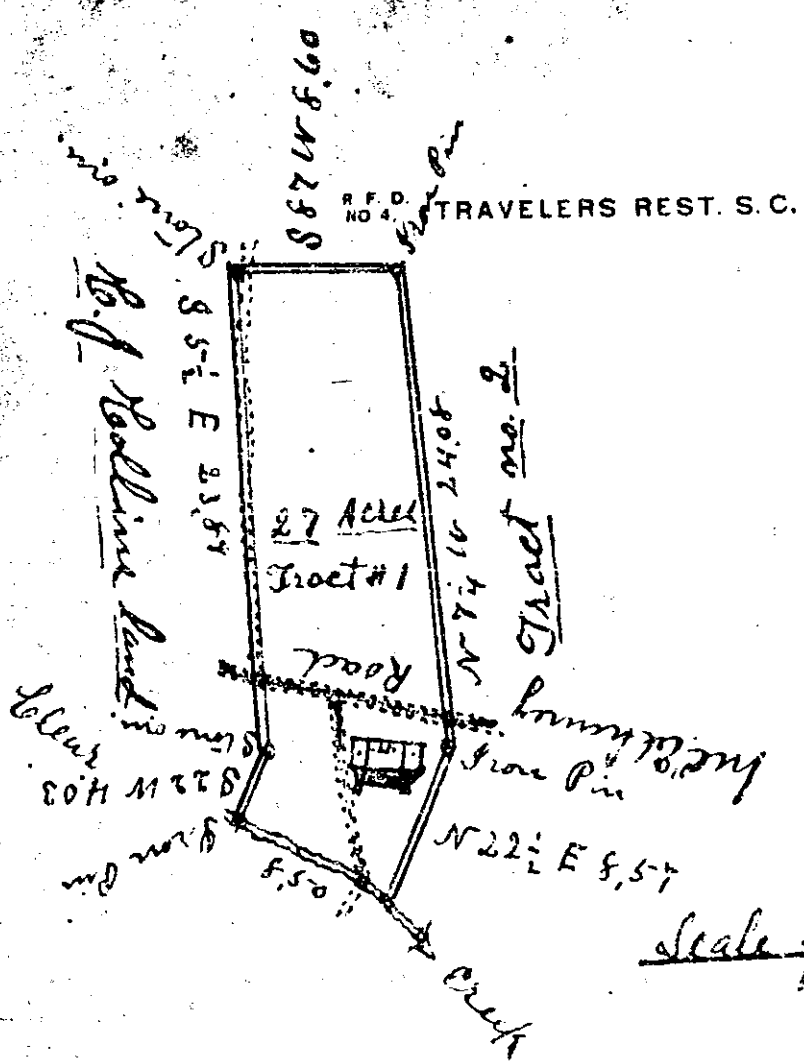

Scale of 10 chs per inch

South Carolina
Greenville County

NOV 28 11 15 AM
ALLIE FARNSWORTH
R.M.C.

By the request of J. B. Powell
I have surveyed and divided
a certain tract of land belonging
to him and the above Tract no. 1
the Home Place, containing 27 Acre
and has such shape marks and
boundaries as the above Plat represents
Surveyed June 1 1923

W. A. Hester
Surveyor